

Phone 503.254.7550
 P.O. Box 33663
 Portland, OR 97292-3663
 southeastexaminer.com
 examiner@seportland.news
 Editor: Nancy Tannler

SE THE SOUTHEAST EXAMINER

Account Representative
 Nancy Tannler
 503.254.7550

IF IT'S IN OUR NEIGHBORHOOD . . . IT'S IN THE EXAMINER

Open rate: \$34 per column inch

Per issue prices listed
 Effective Jan. 1, 2018 - Subject to change with notice

	ONE MONTH CONTRACT	THREE MONTH CONTRACT	ONE YEAR CONTRACT
Mini Ad 2 Col. In 1 Col x 2"	N/A	\$67	\$60
Bus. Card 3 Col. In. (1.85"x 3") or (3.9" x 1.5")	N/A	\$99	\$90
6 Col. In. (3.9" x 3") (3.9"w x 3"h)	\$199	\$170	\$151
Jr. 1/8 8 Col. In. (3.9 x 4")	\$254	\$218	\$180
Jr. 1/4 16 Col. In. (3.9" x 8")	\$478	\$382	\$324
1/4 Page 24 Col. In. (6" x 8")	\$654	\$523	\$417
1/2 Page 40 Col. In. (10.12" x 8")	\$921	\$737	\$625
Full Page 82 Col. In. (10.12" x 16.25")	\$1,417	\$1,205	\$1,083

Rate Card

AD SPECIFICATIONS

The Southeast Examiner is web printed on newsprint. Preferred line resolution 300 dpi. Full color process (CMYK - Maximum color build 235%) is available for \$50 (\$25 under 8 Column inches) our placement. Placement other areas \$300. Specified page placement is \$25 per issue. Typesetting & design by quote. All ad rates are for prepaid camera ready ads.

Circulation: 24,600

Mail Deliveries to
 Homes, Businesses: 23,000
 Street Stands & Stores: 1,600

Print Schedule 2019/2020

Issue	Ads due By Wednesday	Release Date Saturday
Oct	Sept 18	Sept 28
Nov	Oct 23	Nov 2
Dec	Nov 20	Nov 30
Jan	Dec 27(Fri)	Jan 4
Feb	Jan 22	Feb 1
March	Feb 19	Feb 29
April	March 18	March 28
May	April 22	May 2
June	May 20	May 30

**Insert information
By Zip Codes**

All Areas Below

23,000 @.05 ea.. = \$1,150

SE Water Ave (1st)-SE 82nd, E. Burnside (part of Laurelhurst area) to Powell

97202, 97206 6,200 @ .06 ea. = \$360

SE Water Ave (1st)-SE 82nd, Division to Powell :

97214 9,000 @ .06 ea. = \$540

SE Water Ave (1st)-SE 42nd, Burnside to Division

97215 6,600 @ .06 ea. = \$390

SE 42nd-SE 82nd, Burnside to Division

97232/213 1,600 @ .10 ea. = \$160

NE Laurelhurst area

*Above rates are based on single sheet
8 1/2 x 11" 20# stock inserts*

Reader Surveys on Request

The Southeast Examiner is the primary source of local news and events for inner southeast neighborhoods. It is mailed to 21,500 homes, businesses and apartments and delivered door to door to an additional 1,500 homes each month. Another 3,000 copies are available at businesses and street stands in our delivery area for a total print of 26,000. No other paper covers the inner southeast as completely as The Southeast Examiner. Our readers appreciate us because we are the only local newspaper that covers the important issues, people and events in our area. The Southeast Examiner advertising reaches interested, well informed people in your community.

Distribution Area

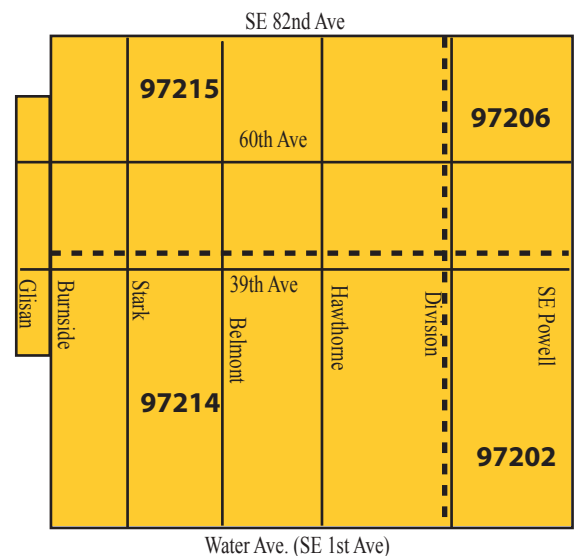

You can also find us on the web at:
southeastexaminer.com

email
examiner@seportland.news